



site analysis

SITE CRITERIA

- o void public (city-owned) space
- o space that is quite commonly found in cities - since this issue (especially homelessness) is quite prevalent in all major cities
- o contested space - space that has been inhabited by individuals but the city maintains a strong degree of control over
- o flexible space - spaces that have varying degrees of change. For example, a park downtown is seldom used at night or on the weekends - can this be a spot for people to inhabit during that time. This can also be seasonal space as well, a public space may be used in the summer, but in the winter it lays vacant.
- o Vacant space - and varying degrees of vacancy - this can apply to a site, or a whole building, or even a whole neighbourhood or district. It has to be a place where someone can come in and settle (at least for a little while)
- o Infrastructure - the space has some kind of existing infrastructure that the inhabitants make use of and build off of. For example, an underpass has an existing overhead shelter in place. One might also be able to make use of water / electricity sources; there might be a spot where there is good soil to grow some vegetables; etc.
- o Opportunity to go beyond shelter. Although shelter is a primary need and goal, there needs to be the opportunity for events to occur after that goal is somewhat met. What do the people do once they settle there?

- o steam connection - steam pipe network exhaust provides resource that otherwise is wasted. The vented steam can be used for heating, water, and even aesthetic uses. Integration of existing infrastructure is a key part of the thesis investigation.
- o contested space - issue of public versus private - the site must exhibit this tension of ambiguity of space use. The sites are located in the middle of the street or sidewalk.
- o the opportunity for growth beyond a public washroom entails that there to be space available to meet those growing needs: health, education, shelter, food, etc.

SPRINGBOARD 1: the pending displacement of Victor Manuel

- * victor manuel's house
- * greening of detroit park and pavilion - questions of public use
- * alley behind foxtown - another current residence
- * garfield & woodward - gathering place
- * financial district garage - flex space?
- * michigan & griswold - lot with steam pipe

MIDTERM:

STEAM INFRASTRUCTURE

CHIMNEY: griswold, gratiot

MANHOLE: monroe + randolph

STREET SIDE

BUS STATIONS: woodward ave, city hall

library/hudson's block

PARK

garden station park (north greektown)

washington blvd.

capitol park? - also bus station

CORNER/ALLEY

foxtown

STEAM INFRASTRUCTURE: reclamation of wasted public resource

TRANSPORTATION (bus shelter): immobility for mobility (wait time)

OPEN PARK: void in density - antidevelopment in a sense

SITES:

griswold:

gratiot:

monroe+randolph

cityhall bus - media centre - newsstand

woodward buses

garden station park -

washington blvd. -

STRATEGY - TACTIC

public washroom - democratic

car wash - utilize the steam, maybe live there for heat, legit to take up street space. making money, culture

recreation area - sit and lounge, goes with eating, music and media

media - information is power (knowledge is power). the right to know. free exchange of thought, includes newsstand

music - space for practice, performance, expression

~~advertising - the easiest way to pay for stuff, but affects identity
consumer or citizen?~~

greenhouse - steam, heat, water, grow stuff. eat it. or sell it.

~~food - coffee / snack bar~~

~~open source - freeware, shareware
open networks~~

site possibilities

Site Possibilities

SPRINGBOARD 1: the pending displacement of Victor Manuel

* victor manuel's house

* greening of detroit park and pavilion - questions of public use

Starting with Victor Manuel's home site, and contemplating what will happen to him when he gets displaced, this study looks at the legitimacy of space claims. Across the street is the Greening of Detroit Park and Pavilion. There stands a beautiful structure there, but what makes that a legitimate claim over that space, versus Victor Manuel's squatting on a site. Is it because it is not a clean, well-kept parkette? Is it because he doesn't pay any property tax? Is it because the land legally belongs to somebody else - somebody who is not doing anything with the property now, but waiting for the cash cow to come in the near future? Who does space really belong to? The person who paid for it but doesn't live there, or the person who didn't pay for it but is living there?

victor manuel's home / greening of detroit park and pavilion



Site Possibilities

SPRINGBOARD 1: the pending displacement of Victor Manuel

- * victor manuel's house
- * greening of detroit park and pavilion - questions of public use

This is Victor's house. It is made up of scraps he has found in the vicinity and has carted back to the site. His background in construction allows him to create a pretty elaborate shelter. It has structural columns and wood framing, masonry walls, a ramp to the roof, and even electrical conduit.



victor manuel is originally from honduras. he is a construction worker and has built his home out of scraps he has found. the city plans development will displace his home.

gas across site N-W-E



rebar and masonry block

phase 2 in progress



ramp leading to roof

masonry wall, wood columns



fence and curb cut



entry, ramp and shelter



electrical conduits wired into wall



garbage? resources?



gas leading west from site

victor manuel's home
41700000 - 42000000 - DETROIT MI

Site Possibilities

SPRINGBOARD 1: the pending displacement of Victor Manuel

- * victor manuel's house
- * greening of detroit park and pavilion - questions of public use

The Greening of Detroit Park and Pavilion is located on the north side of Jefferson. In contrast to Victor's site, this park is somewhat well kept, sanitary, quite empty and lonely except for the occasional person getting off the bus and cutting through the park. The pavilion is a very beautiful structure, but no one really uses it. So, what is the shelter for? Who is it supposed to shelter? Imagine if the shelter became a true shelter for somebody, maybe Victor. How different would it be? At least there is electricity at this site.



Site Possibilities

SPRINGBOARD 1: the pending displacement of Victor Manuel

- * financial district garage - flex space?
- * michigan & griswold - lot with steam pipe

The Financial District Garage is pretty much vacant on the the upper levels during the bulk of the year. Perhaps with the exception of major events the garage would see a higher influx of vehicle parking.

Across the street there is a vacant lot with a steam exhaust pipe. Is this a potential resource that can be harnessed for other uses?



Site Possibilities

SPRINGBOARD 1: the pending displacement of Victor Manuel

* financial district garage - flex space?

There is so much vacant space up here. If you paid \$5 to park, is that essentially like renting that parking space? If the parking garage is used during the day but largely vacant at night, is there a possibility of instituting a time-share idea of space?



Site Possibilities

SPRINGBOARD 1: the pending displacement of Victor Manuel

* michigan & griswold - lot with steam pipe

Can all of the exhausted steam be captured for its heat and water?



Site Possibilities

SPRINGBOARD 1: the pending displacement of Victor Manuel

* alley behind foxtown - another current residence

In an alley way behind the foxtown entertainment venues, another "homeless" person has made a shelter out of the existing infrastruuctual framework. The legitiacy of this is in it's informality and that it is tucked away in an alley behind an abandoned building.



Site Possibilities

MIDTERM:

STEAM INFRASTRUCTURE

CHIMNEY: griswold, gratiot

MANHOLE: monroe + randolph

STREET SIDE

BUS STATIONS: woodward ave, city hall

library/hudson's block

PARK

garden station park (north greektown)

washington blvd.

capitol park? - also bus station

CORNER/ALLEY

foxtown

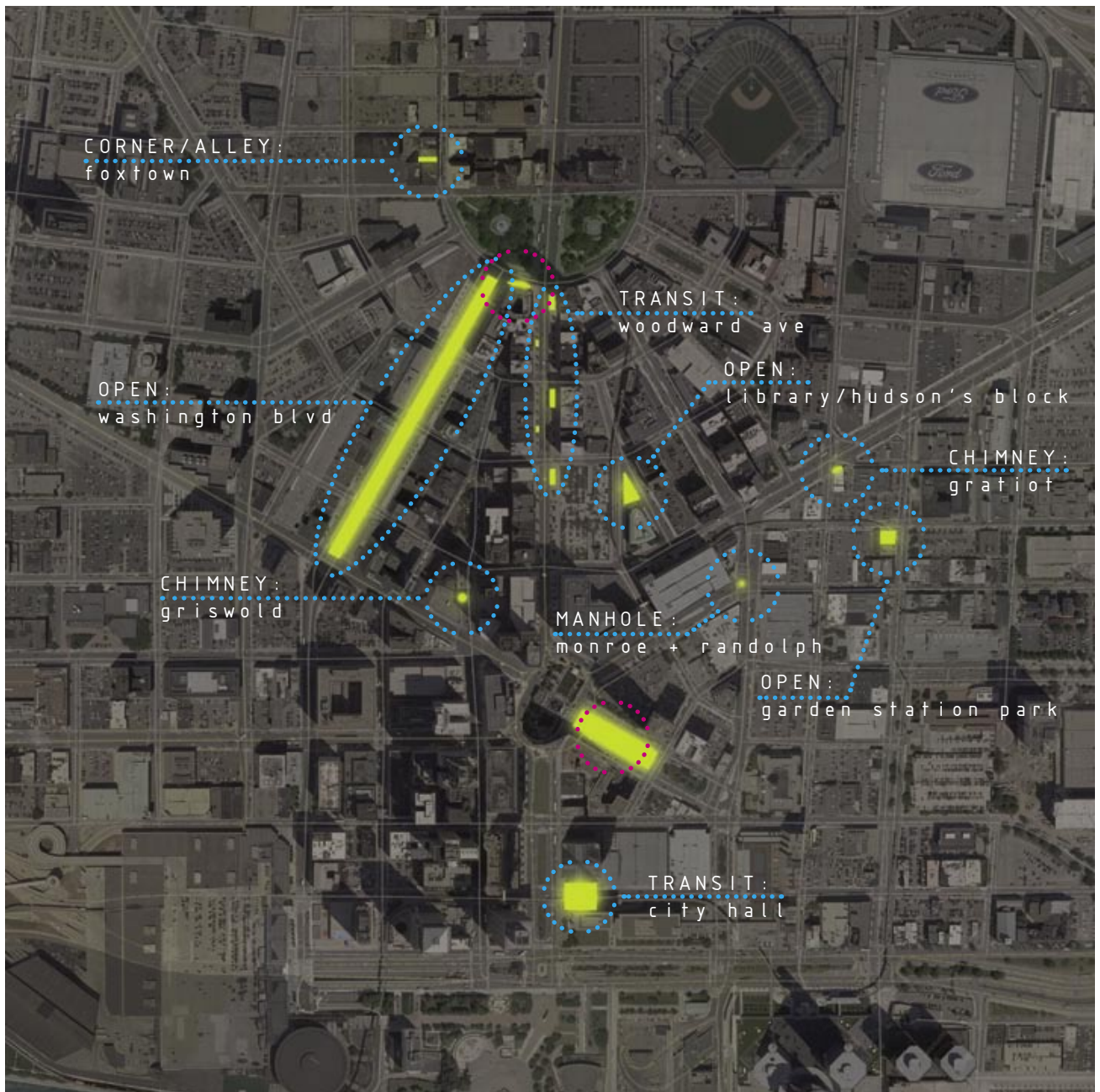

Site Possibilities

SITE STRATEGY - TACTIC

steam infrastructure
bus station
open park

public washroom
car wash
~~recreation area~~
greenhouse
media
~~advertising~~
food - ~~coffee / snack bar~~
music

SITES:
griswold:
gratiot:
monroe+randolph

open source - freeware, shareware
open networks

cityhall bus - media centre - newsstand
woodward buses

garden station park -
washington blvd. -

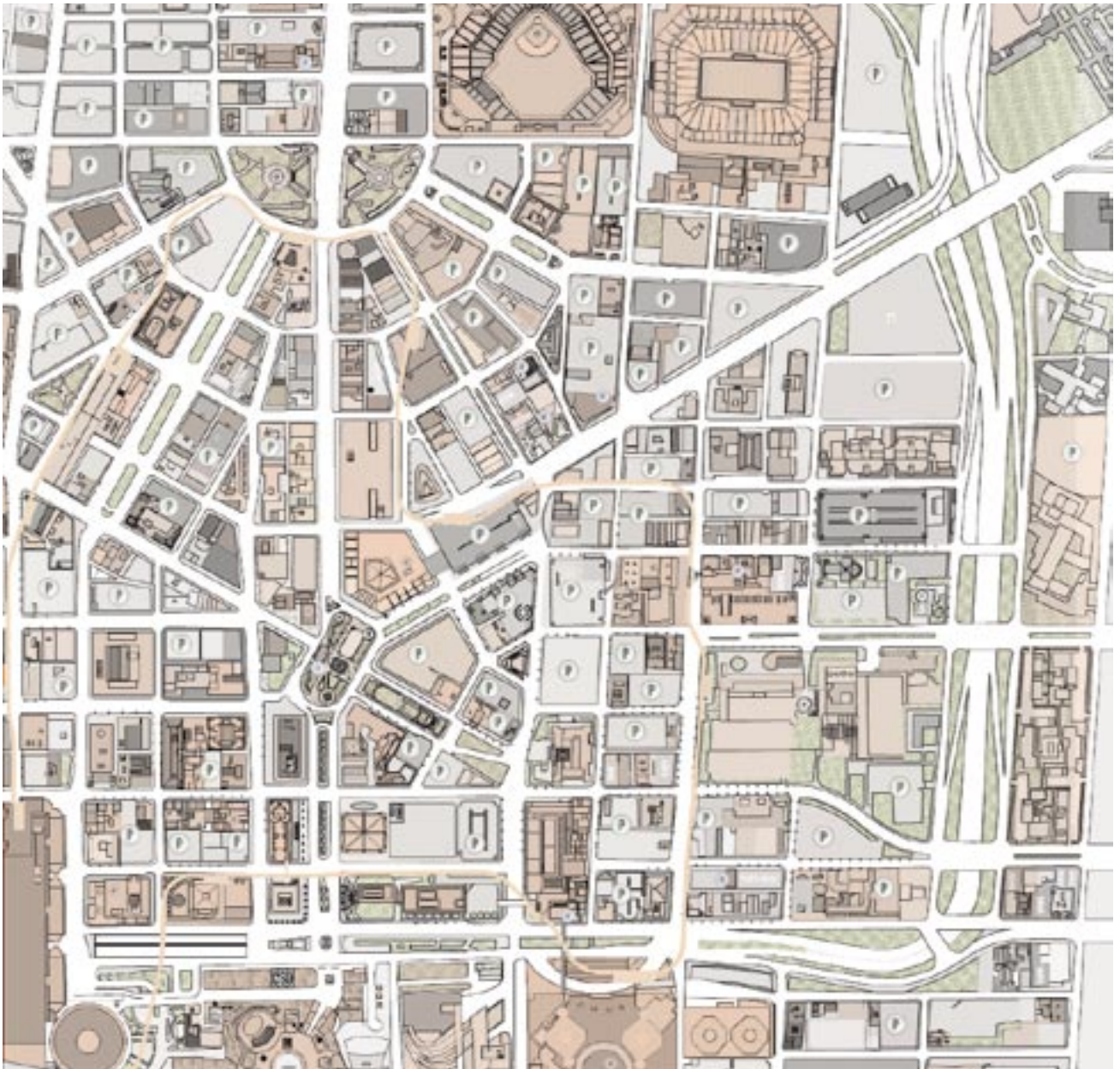

Site Possibilities

SITE ANALYSIS

Map diagrams of downtown:
shades of red indicate the rate of use
deeper shades indicate heavier traffic and activity





springboard studies

Springboard Studies 1

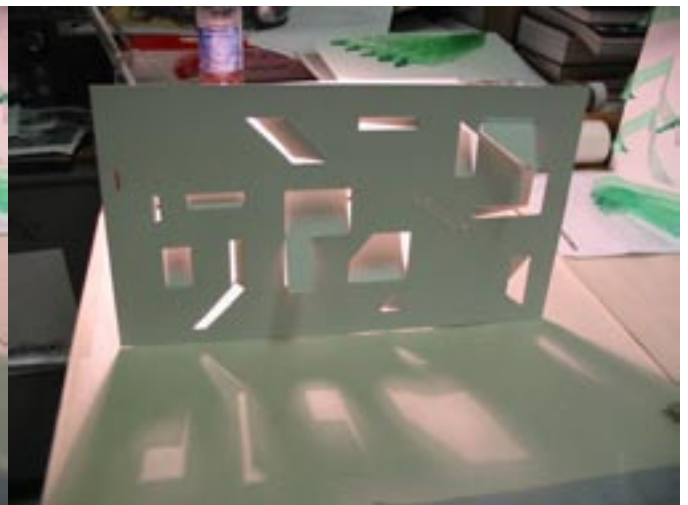
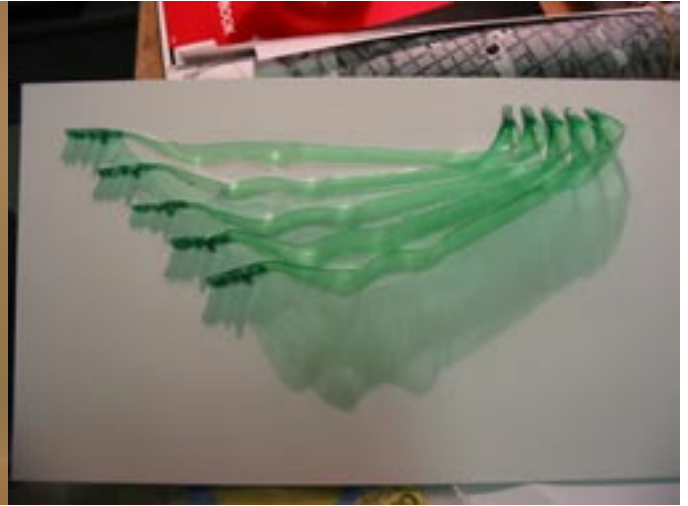
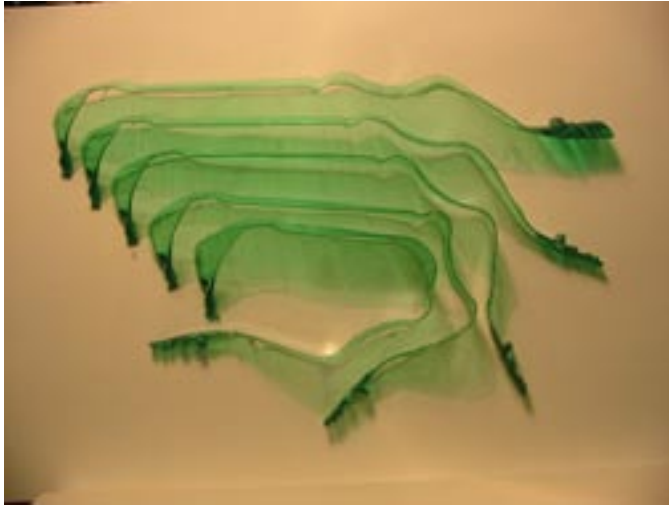

studies for screens and layers/levels of interaction/interface



implementation of screen in alley setting - what is public/private?
 does a "homeless" person have a home?
 what part of the alley way belongs to them?



open / close
 parking structure is open to cars
 closed to anyone with no "business" being there
 can this vacant space above be shared in a way that allows for it to
 be open and closed?
 model examines levels of enclosure and privacy/publicity



utilize existing infrastructure
tactical appropriation of resources
rethink waste rethink use

attempt at capturing steam
for heat and water.

the device takes the ex-
haust from the steam pipe
and redirects it. Maybe
the emergency stairs on the
side of the building can be
spaces for activities such
as sleeping or lounging,
etc. Now there is some
heat.



Greening of Detroit Park and Pavilion.
What if Victor moved here?
If he is homeless, then is this park his
"home"?

And if so, how is it shared with the
rest of the community?

How private should it be?
How public should it be?



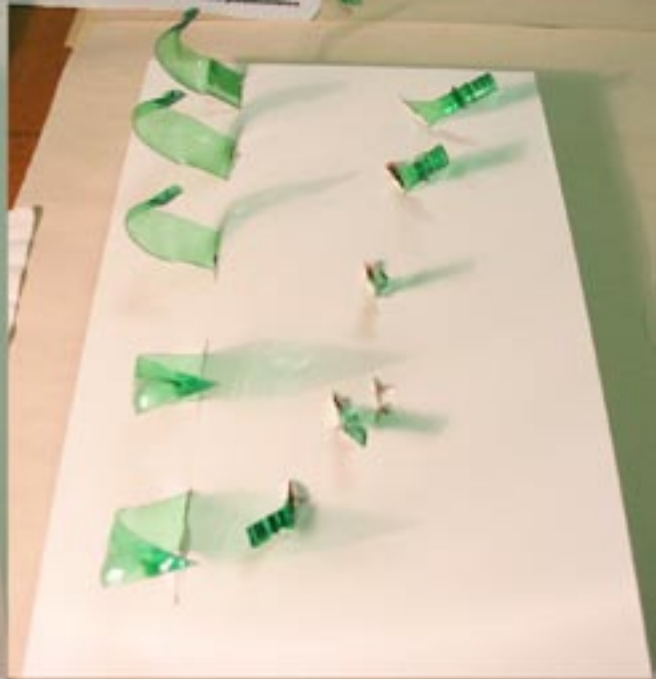
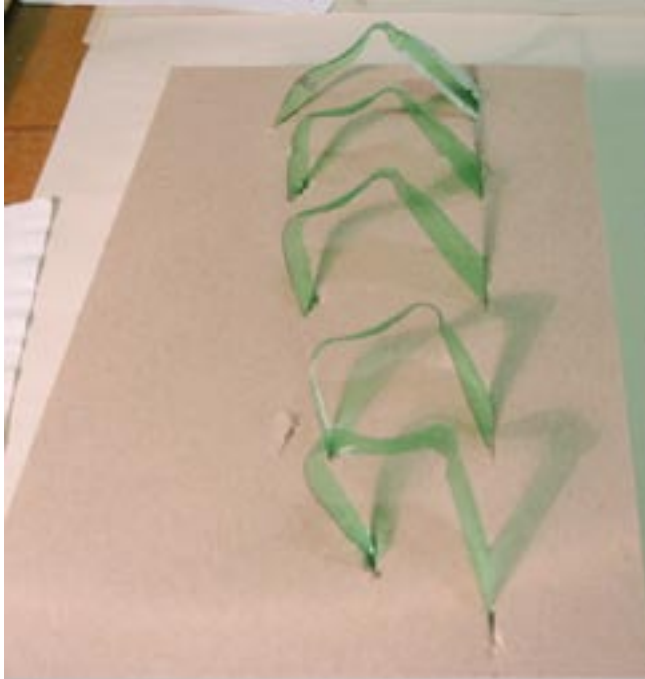

open stairs

wall inhabitation studies

closed loops





dwell within the gaps of infrastructure
 change comes subtly by utilization of public infrastructure
 occupy and thereby claiming public space for the public



how does a homeless person settle?
 is their "home" private though it exists in the wide open public?
 where is the line drawn between public/private space?

*"You would have little hesitation snooping around a
 homeless person's area,
 but it would be very bold to just enter another person's
 actual house and see what they were up to."
 - Jared VanderWeele*

Springboard Studies 2

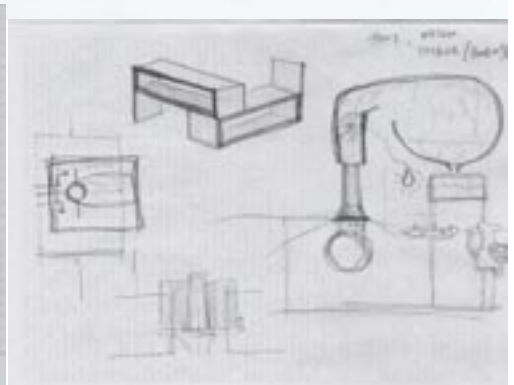
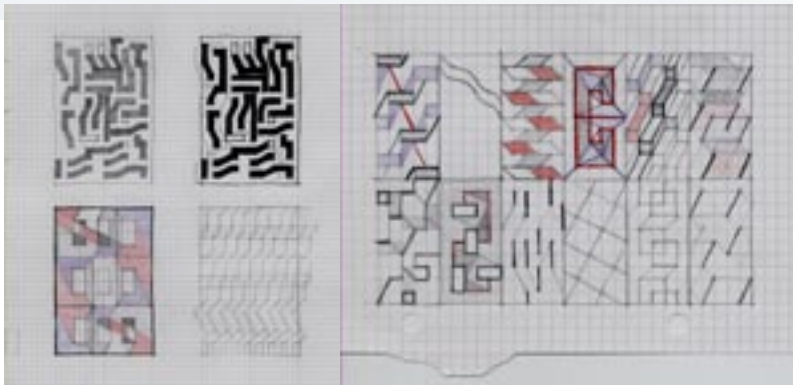
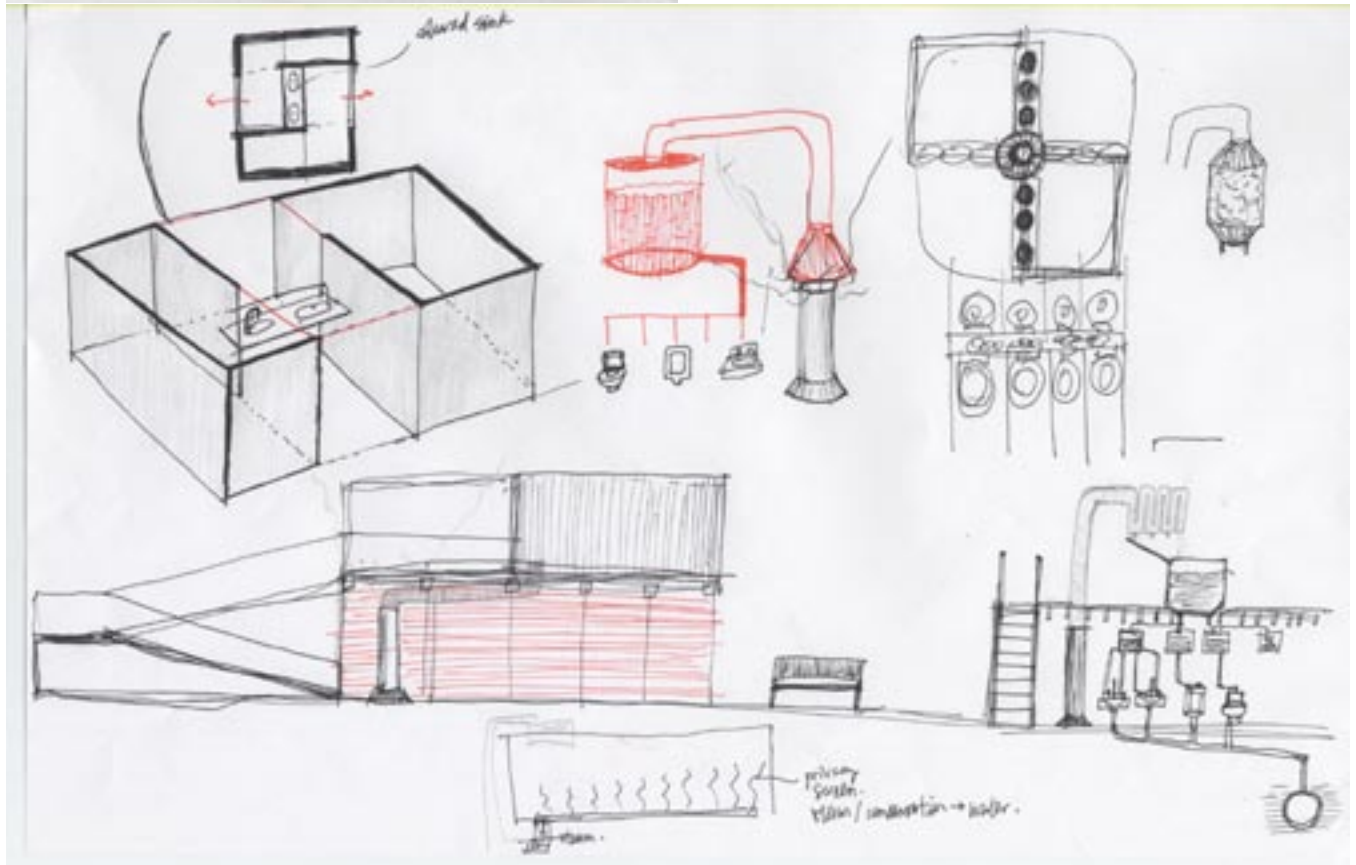
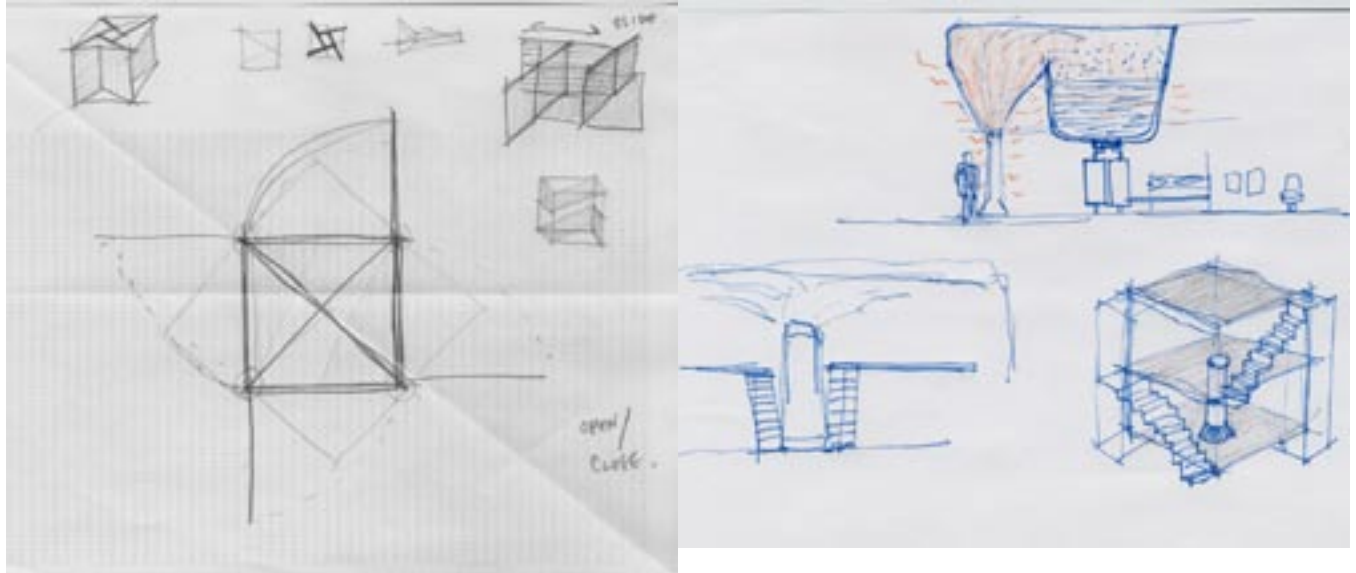

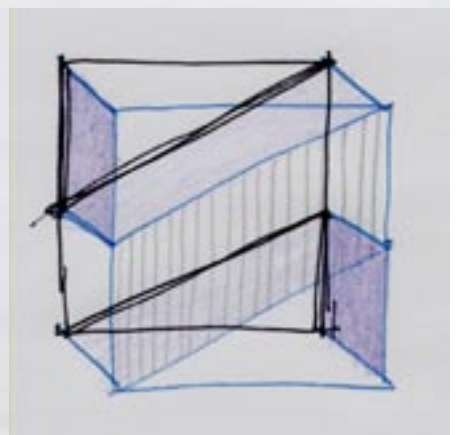
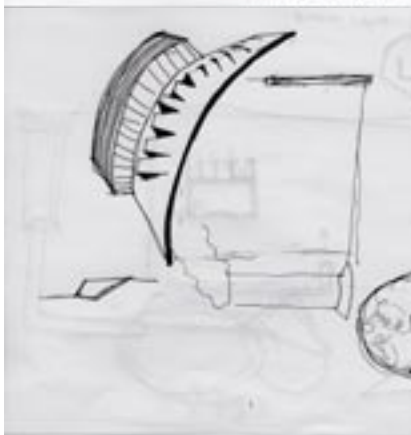
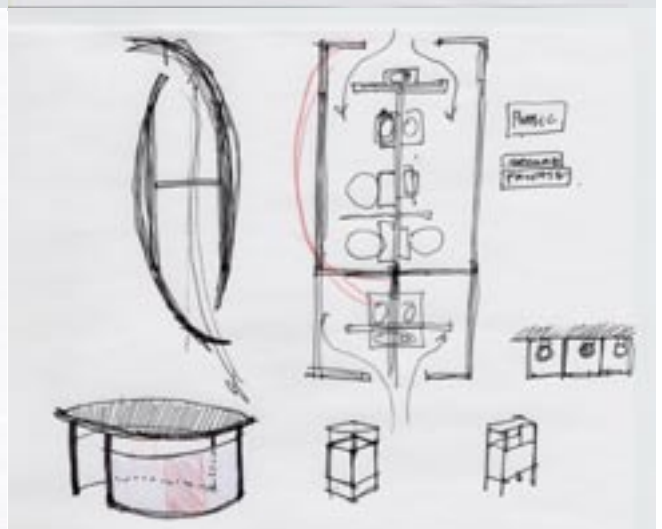
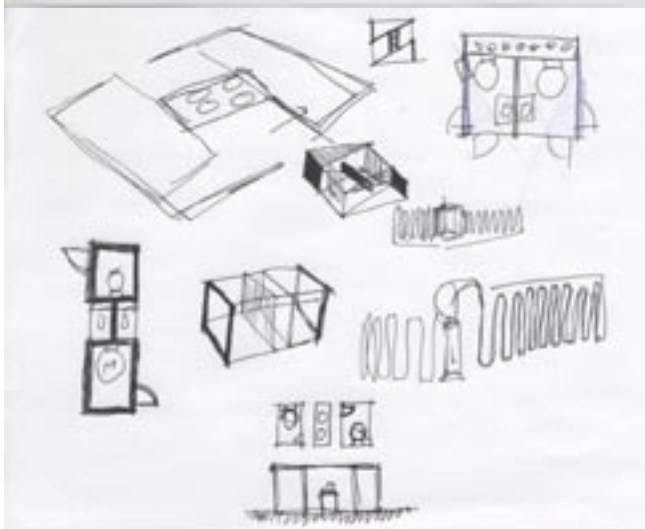
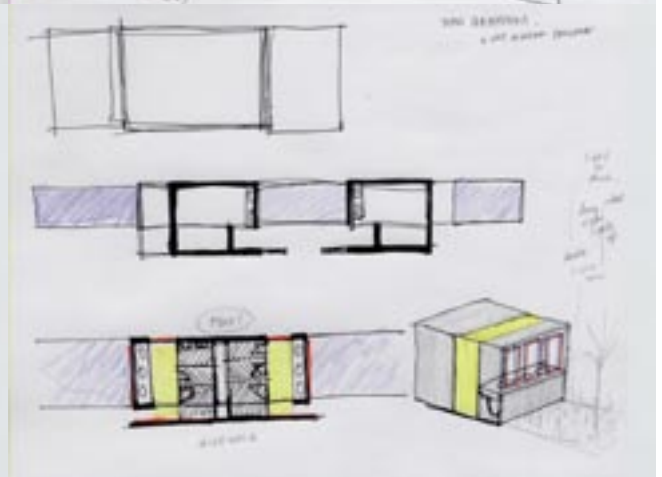
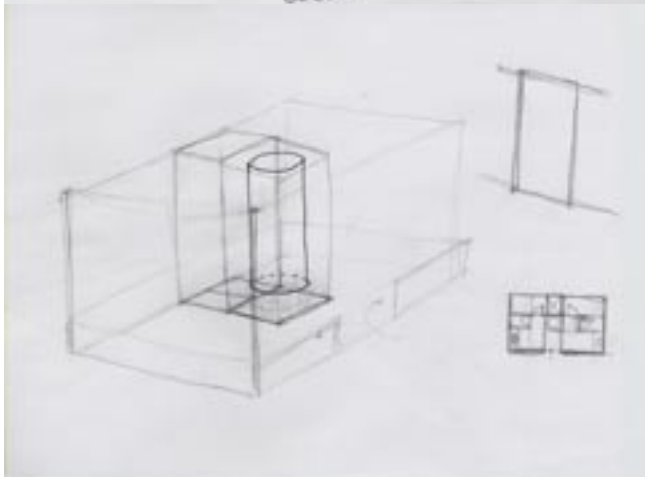
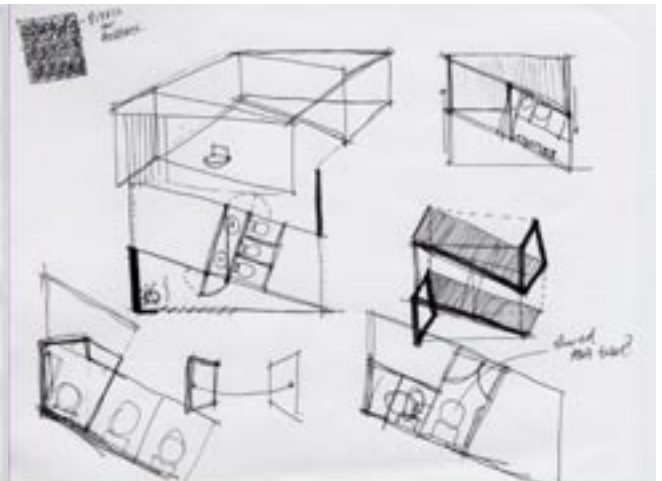
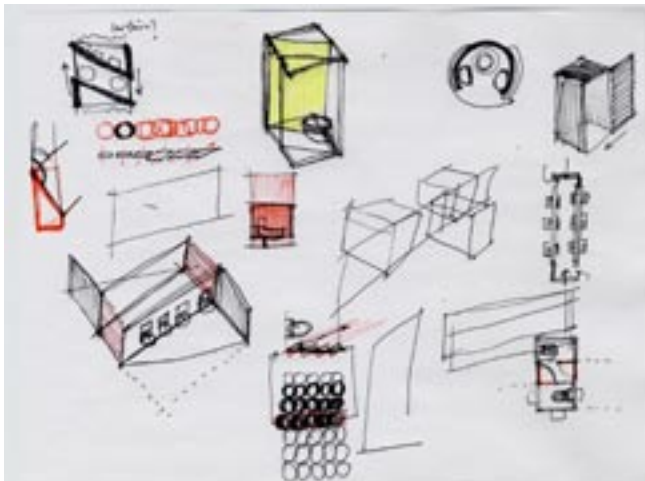

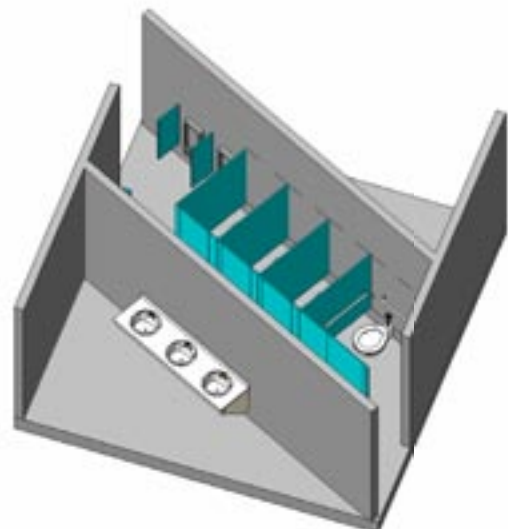
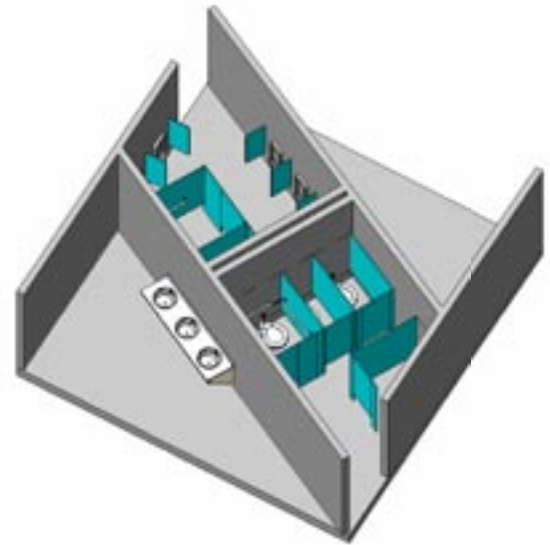
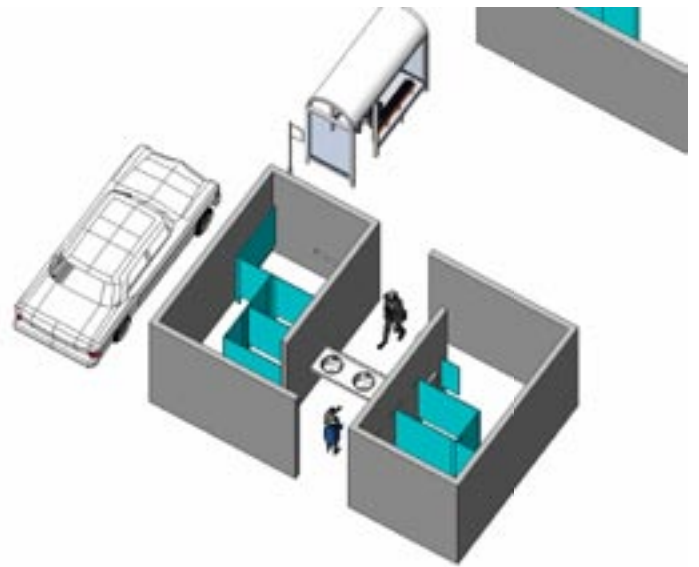

LAYOUT STUDIES
shared sinks, outside sinks, shared utilities

E. J. Marey,
Geometric Chronophotograph of the man in the black suit,
1883



screen studies
stacked toilet paper rolls, pvc pipes/tubes, etc.

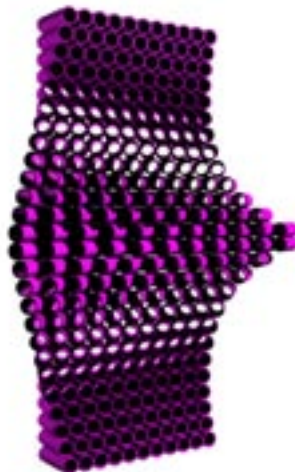
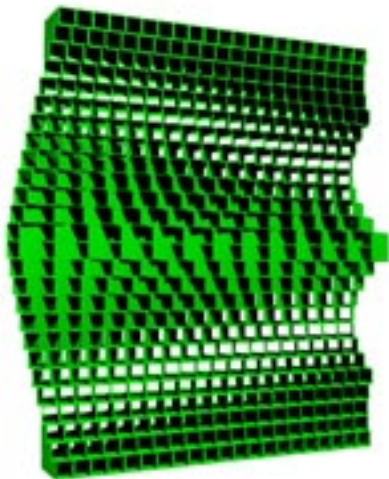
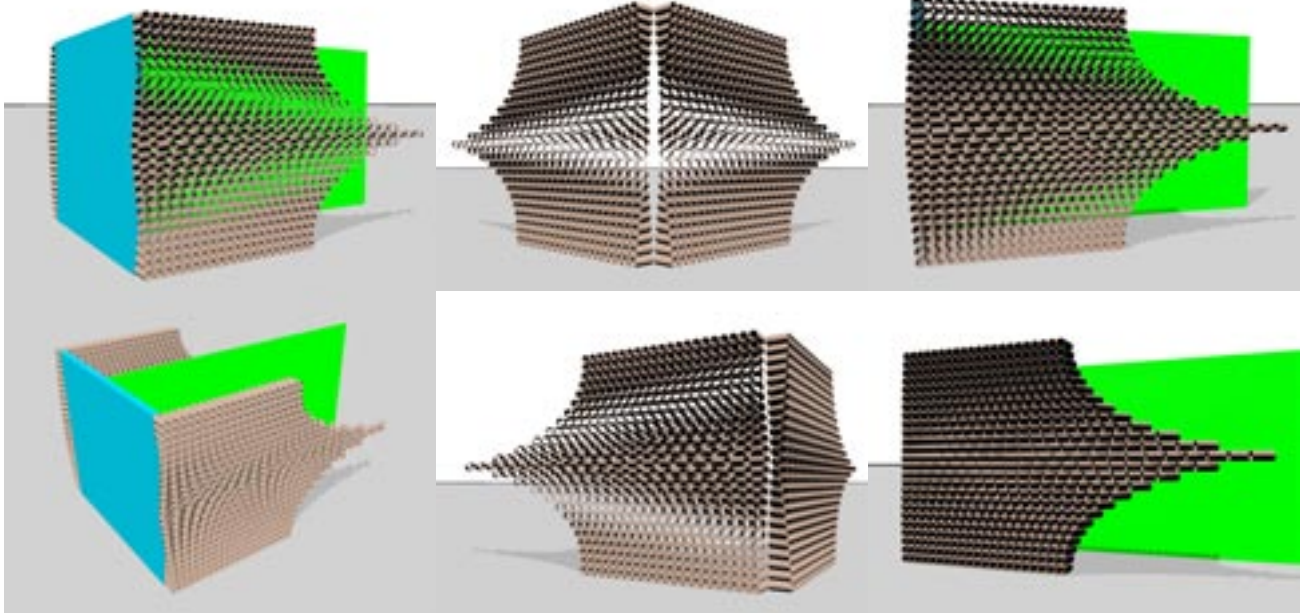

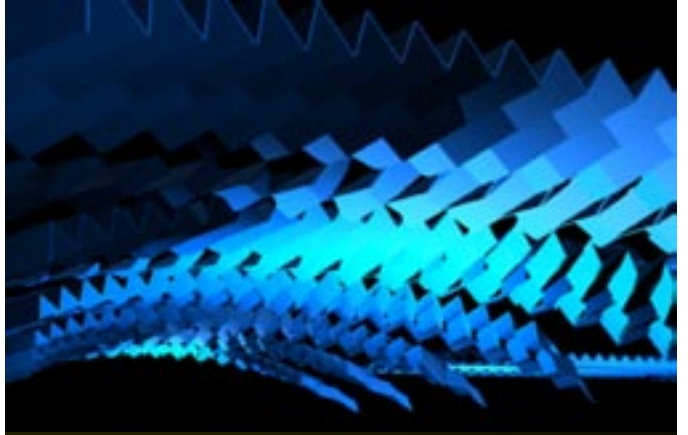
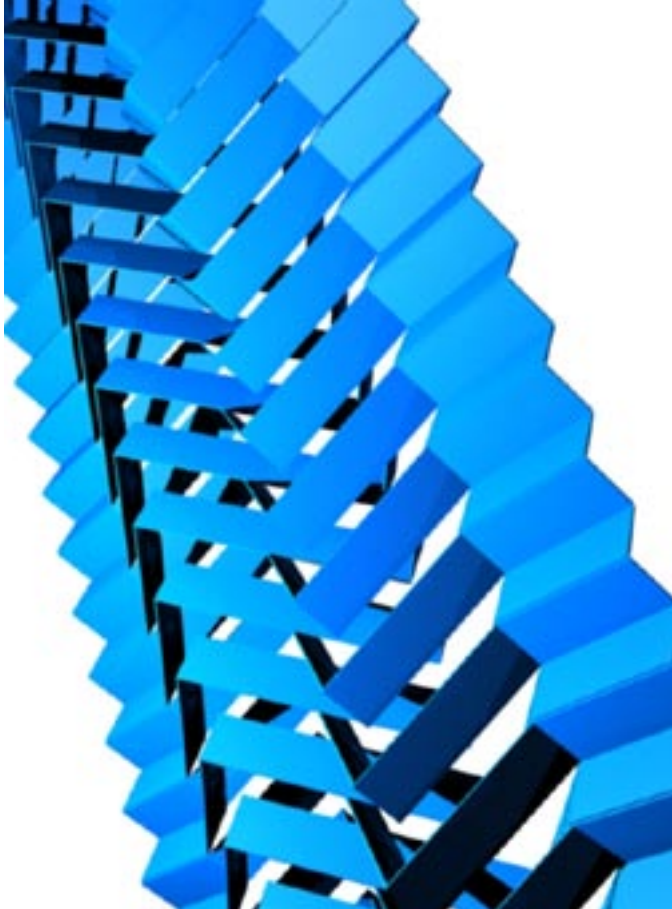
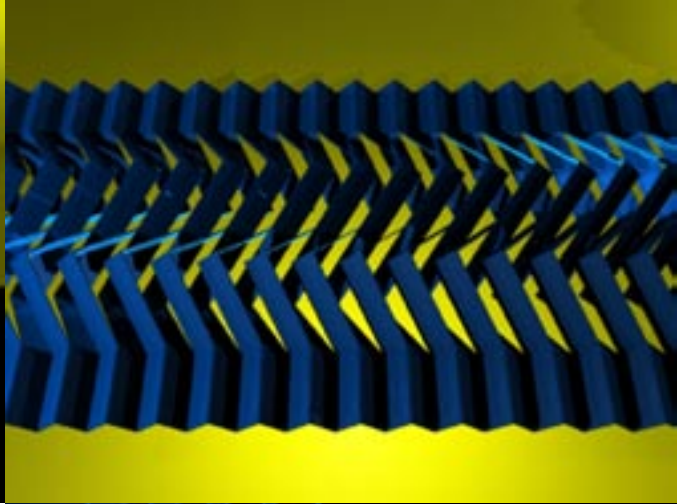
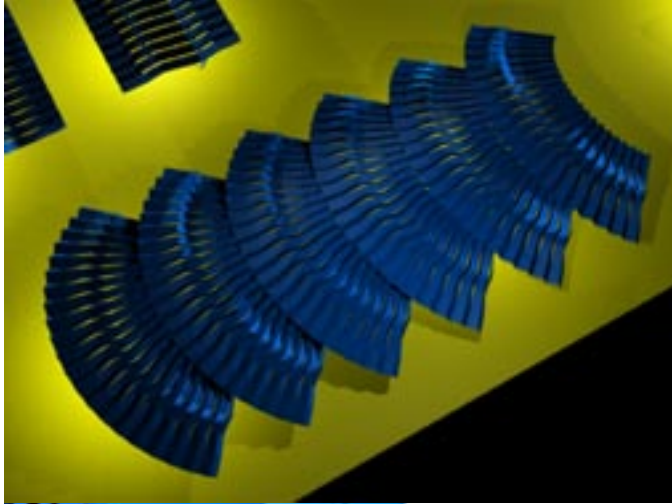
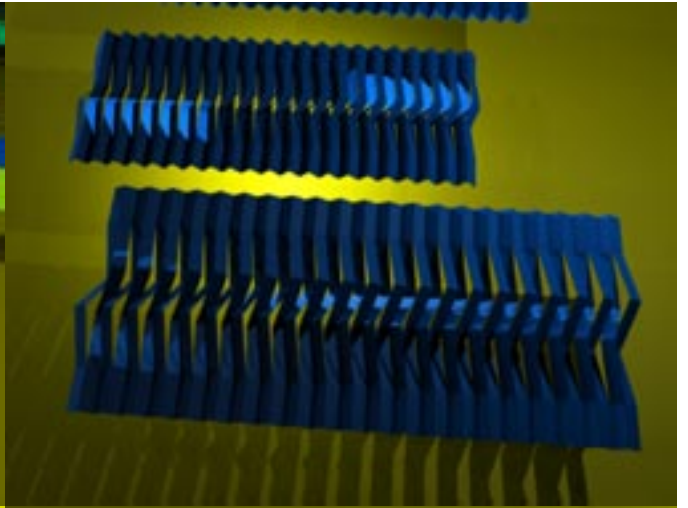
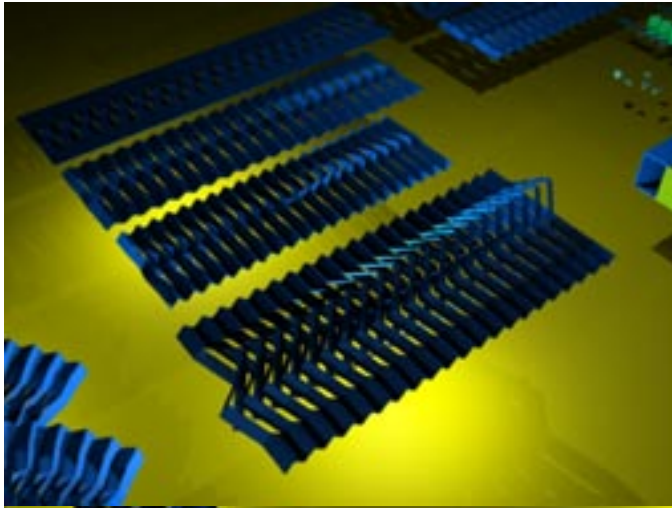

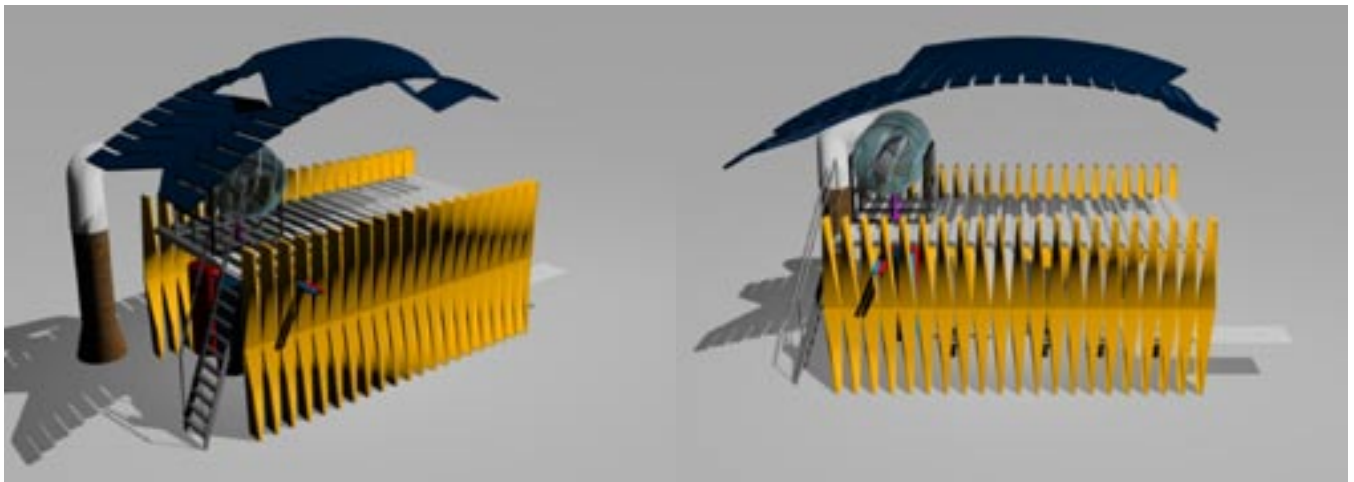
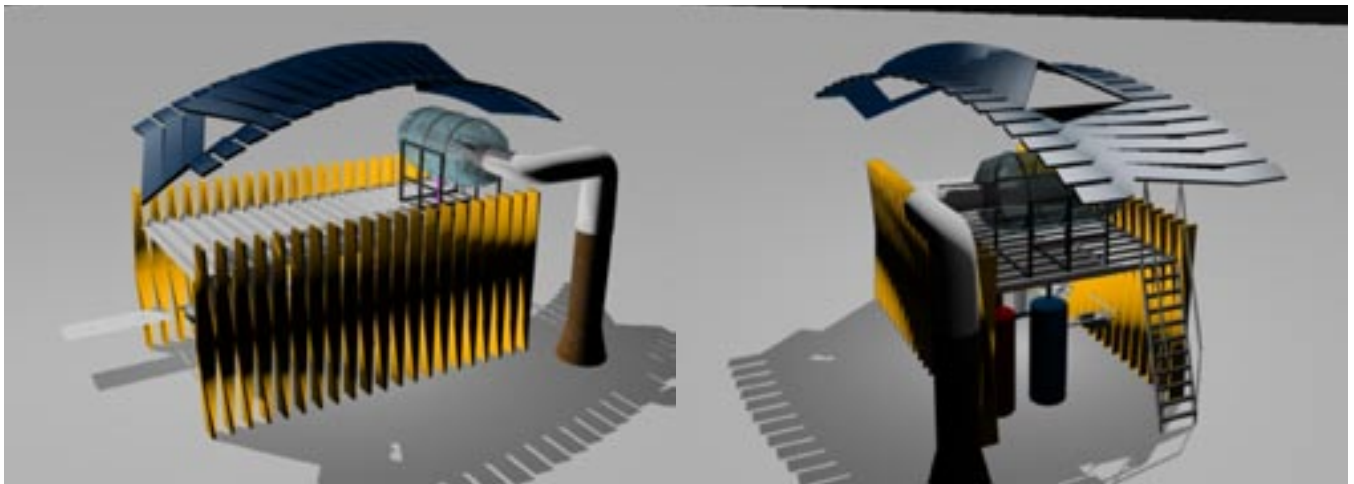
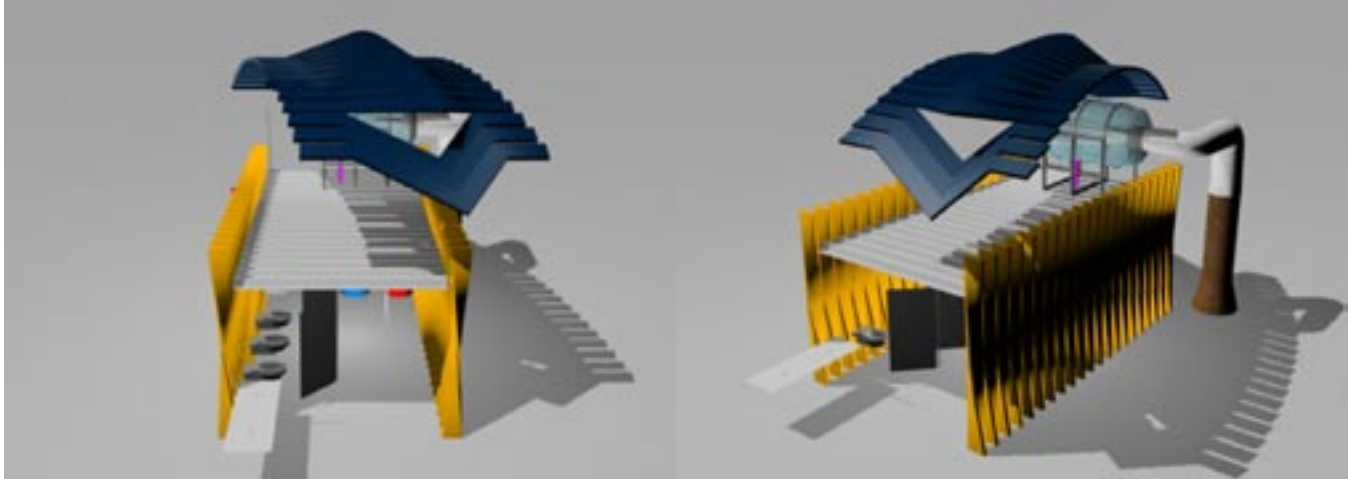

WASHROOM PROTOTYPE
attaches to steam pipe
condenses steam and stores in tank

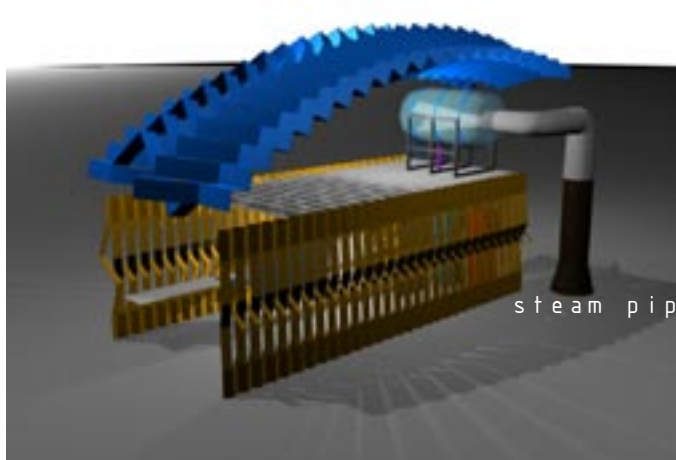

steam pipe

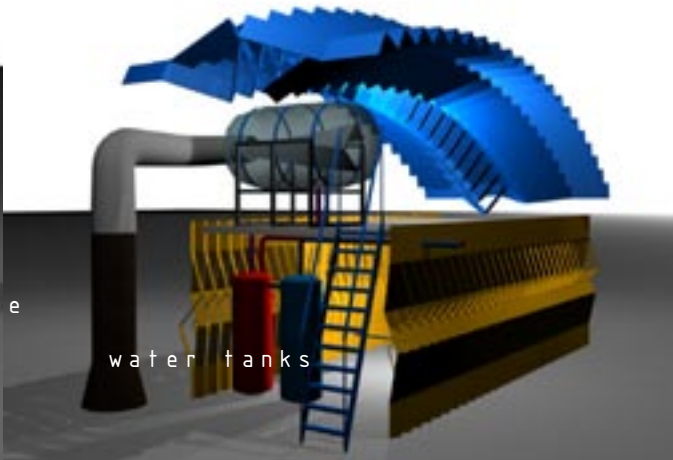

water tanks

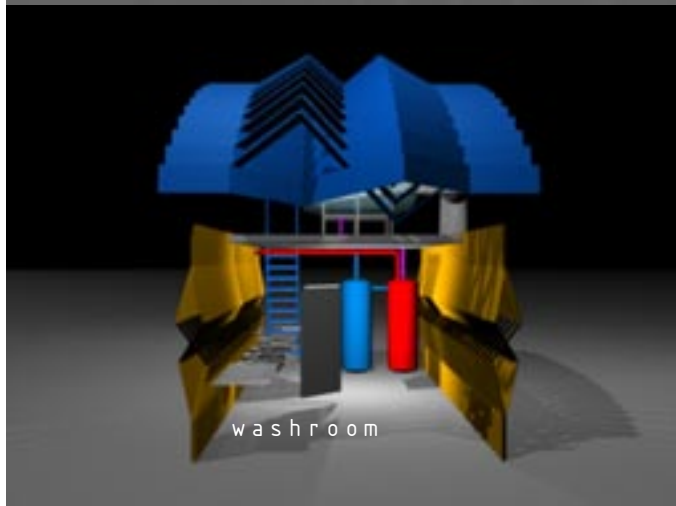

washroom

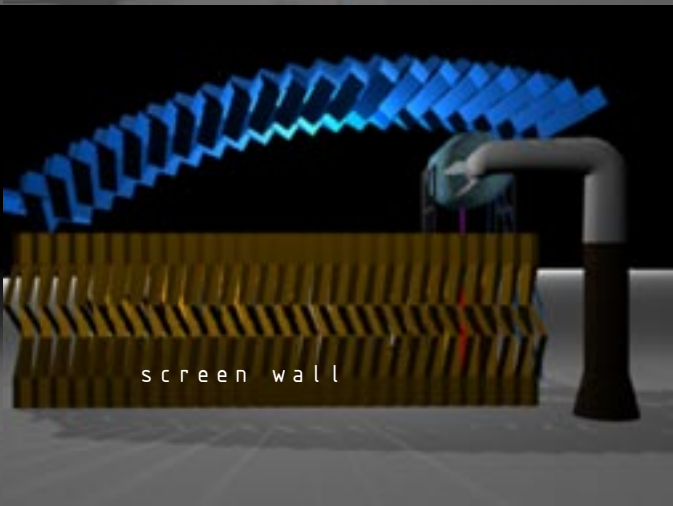

screen wall

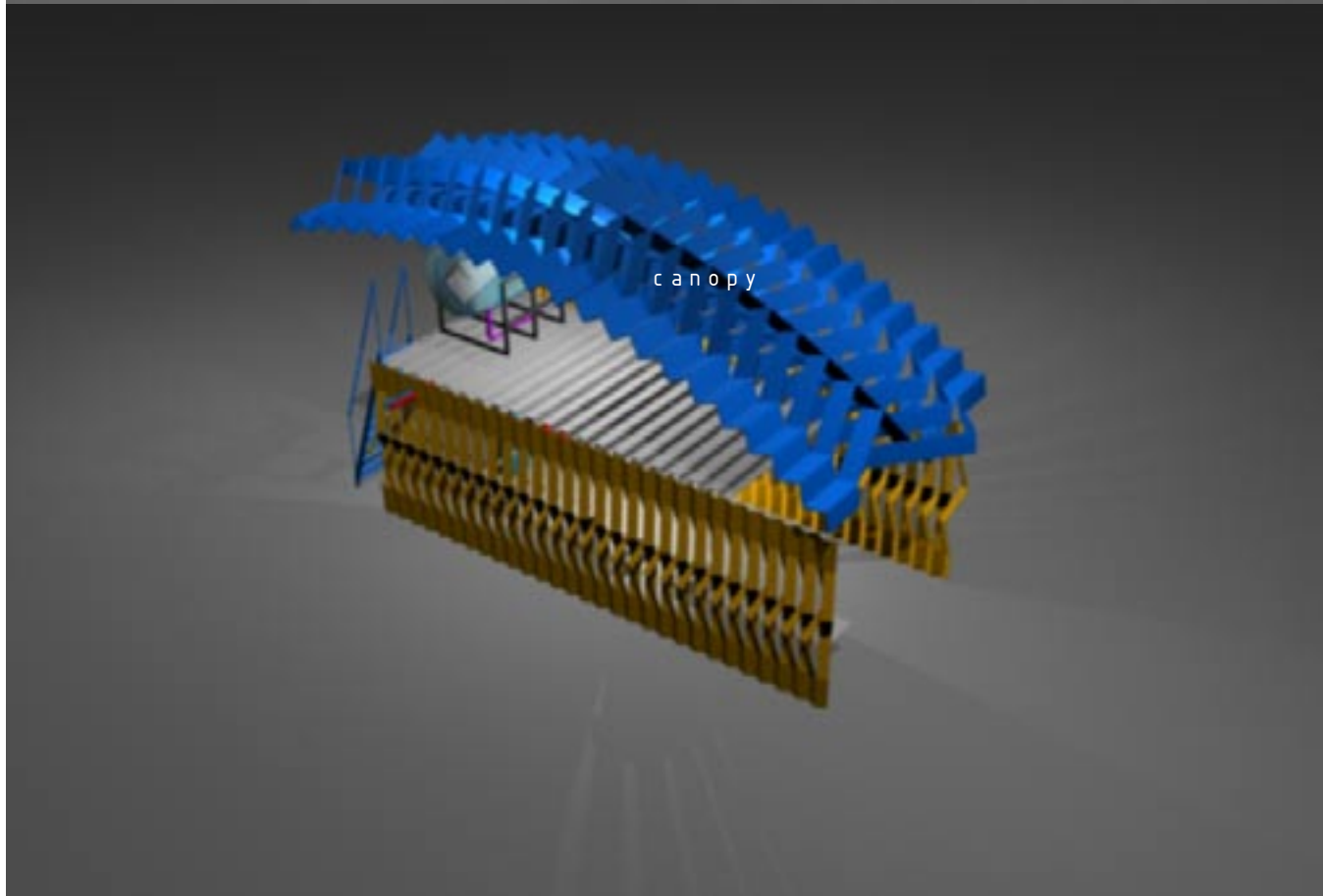

canopy





steam location does not interfere with traffic patterns

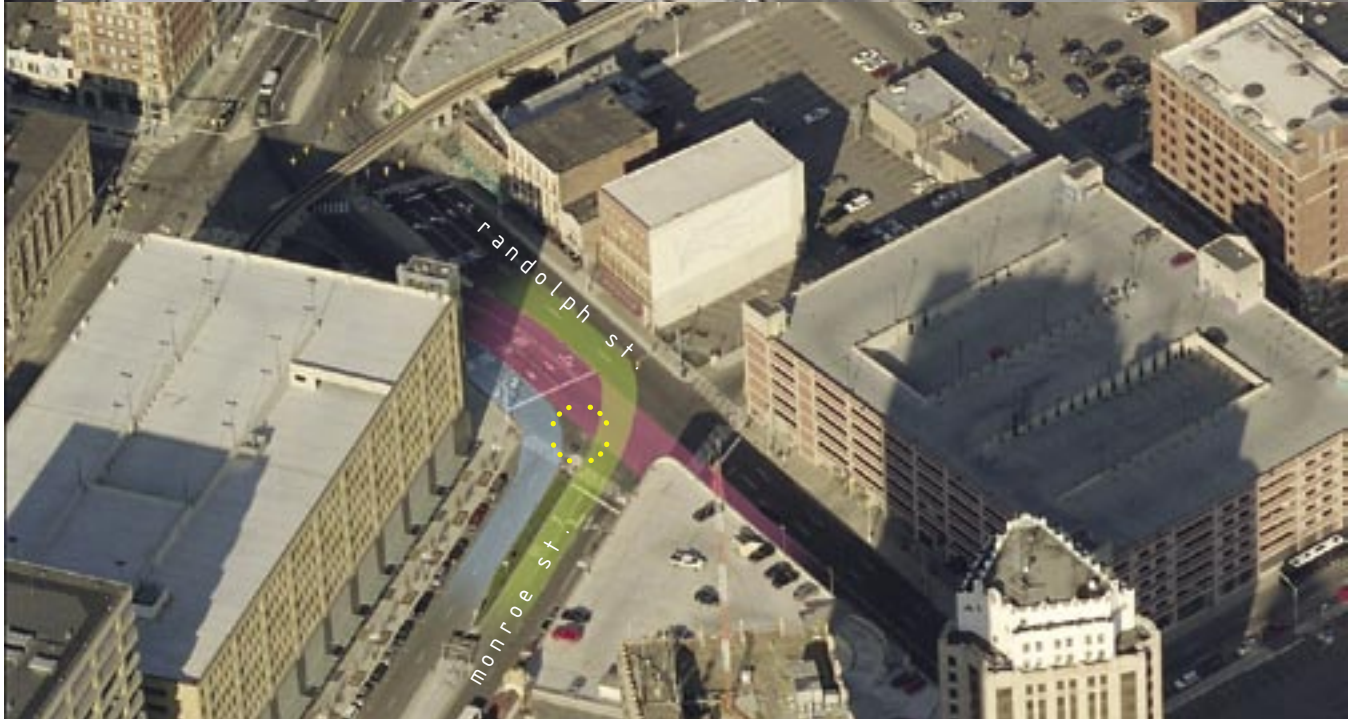

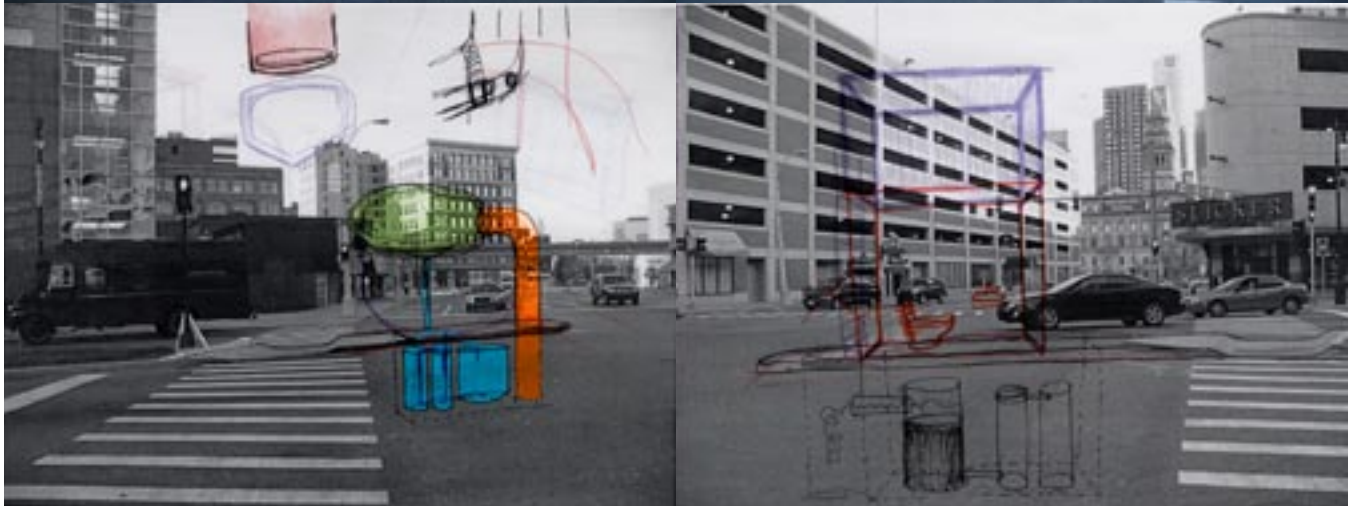

monroe & randolph site study
 manhole (no man's land) all the traffic misses it
 steam washroom studies





streetside installations



washington blvd. (above)
 studies in using the open
 park spaces



gratiot steam pipe site
 (right)
 studies for gateway over the
 street, and kinds of screens.







garden station park site
washrooms under the people mover
infrastructure.

